



QUICK REFERENCE GUIDE

CT160, CT260

EN - 9828/GCE00 - ISSUE 1 - 04/2026

The information shown in this Quick Reference Guide is taken from the Operator's Manual (9831/7750).

This Quick Reference Guide DOES NOT replace the Operator's Manual. You MUST read ALL the disclaimers and safety and other instructions in the Operator's Manual before initially operating this product. Accordingly, no legal claims can be entertained based on the data, illustrations or descriptions in this Quick Reference Guide.

Component Locations

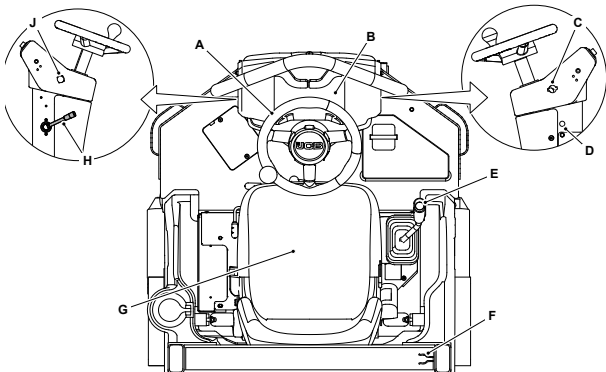

- A** Steering wheel
- B** Front console switches and instrument panel
- C** Ignition switch
- D** Auxiliary power socket
- E** Drive lever
- F** Fire extinguisher mounting bracket
- G** Operator seat
- H** Hand throttle control
- J** Emergency stop button

Instrument Panel

The instruments and warning lights are grouped together on an instrument panel.

When a warning light comes on an alarm will sound (depending on severity of the condition). The only way to cancel the alarm is to set the ignition switch to position '0'. The problem can then be rectified.

Do not use the machine if it has a fault condition, or you may damage the engine and/or the transmission.

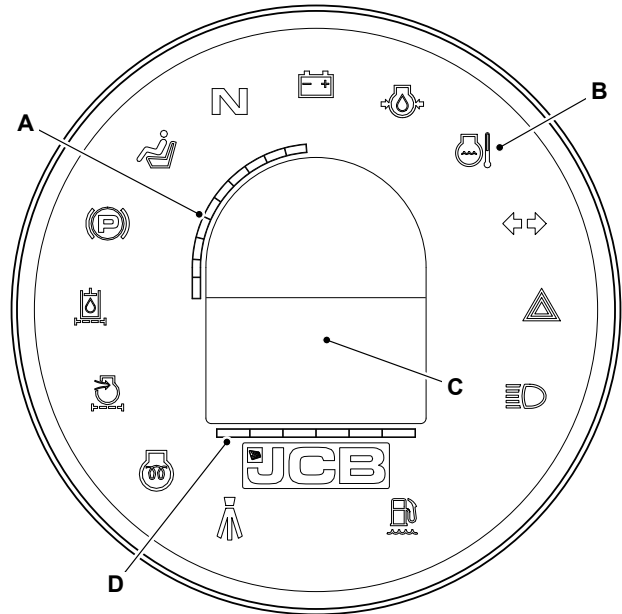

- A** Fuel level indicator bar
- B** Warning and notification symbols
- C** Hourmeter
- D** Battery voltage indicator bar

Warning and notification symbols

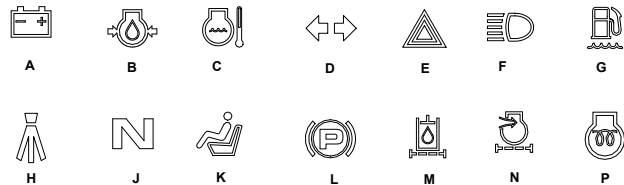

A	Battery charging condition	Audible/Visual. The lamp illuminates and buzzer will sound, if battery is not charging while engine is running. If battery is charging, the lamp and buzzer should go off a few seconds after the engine is started.
B	Engine low oil pressure	Audible/Visual. Illuminates if the engine oil pressure drops too far. Illuminates when the ignition switch is set to position 'I' before starting the engine but should extinguish when the engine starts, if this light remains 'on' stop the engine immediately.
C	High coolant temperature	Audible/Visual. The light will illuminate when the engine coolant temperature is too high. Stop the machine immediately and remedy the fault.
D	Direction indicator	Visual only. Illuminate with the direction indicators. Use the direction indicators to signal before you turn the machine.
E	Hazard warning indicator	Visual only. Flashes with the hazard warning lights. Turn the flashers on when your machine is a possible hazard.

F	Main beam	Visual only. Lights up when the headlight main beams are switched on. Turn the main beams off for on-coming traffic.
G	Water in fuel	Visual only. Illuminate when water in fuel is detected.
H	Water sprinkler	Visual only. Illuminate when water sprinkler is on.
J	Neutral	Visual only. Illuminate when driver lever is in neutral position.
K	Seat switch	Visual only. Illuminate when operator is not sat on the operator seat.
L	Parkbrake on	Visual only. Illuminates when the park brake is engaged.
M	Hydraulic oil filter	Visual only. Illuminate when hydraulic oil filter is blocked.
N	Engine air filter blocked	Audible/Visual. Illuminate engine air filter is blocked.
P	Engine pre heat	Visual only. Illuminate when engine pre heat is on.

Hand Throttle

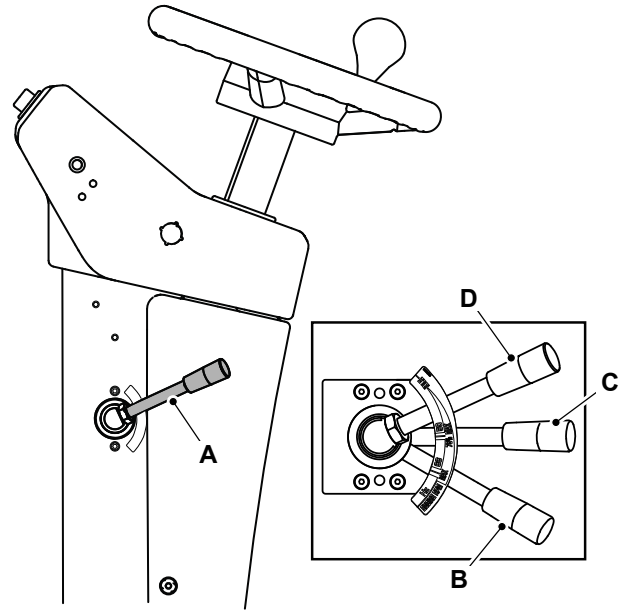

- A Hand throttle control
- B Operating position at 66Hz
- C Operating position at 50Hz
- D Idle position

Do not adjust the speed of the machine with the throttle, always use the drive lever.

Basic Controls

Drive Lever

The drive lever has three positions: forward, neutral/park brake and reverse.

Use the drive lever for changing the driving direction and speed adjustments.

When you start or stop the engine, make sure that the drive lever is in the park position and that it has locked in position.

The engine will only start when the drive lever is in the park brake position.

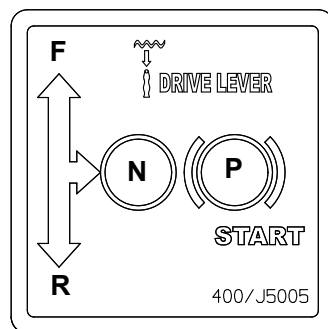
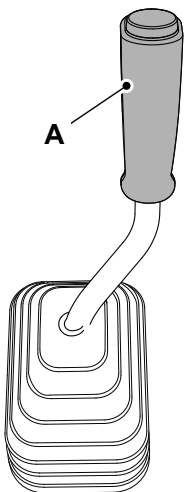

- A Drive lever
- F Forward drive position
- R Reverse drive position
- N Neutral position
- P Park brake position

Switches

Drive Mode

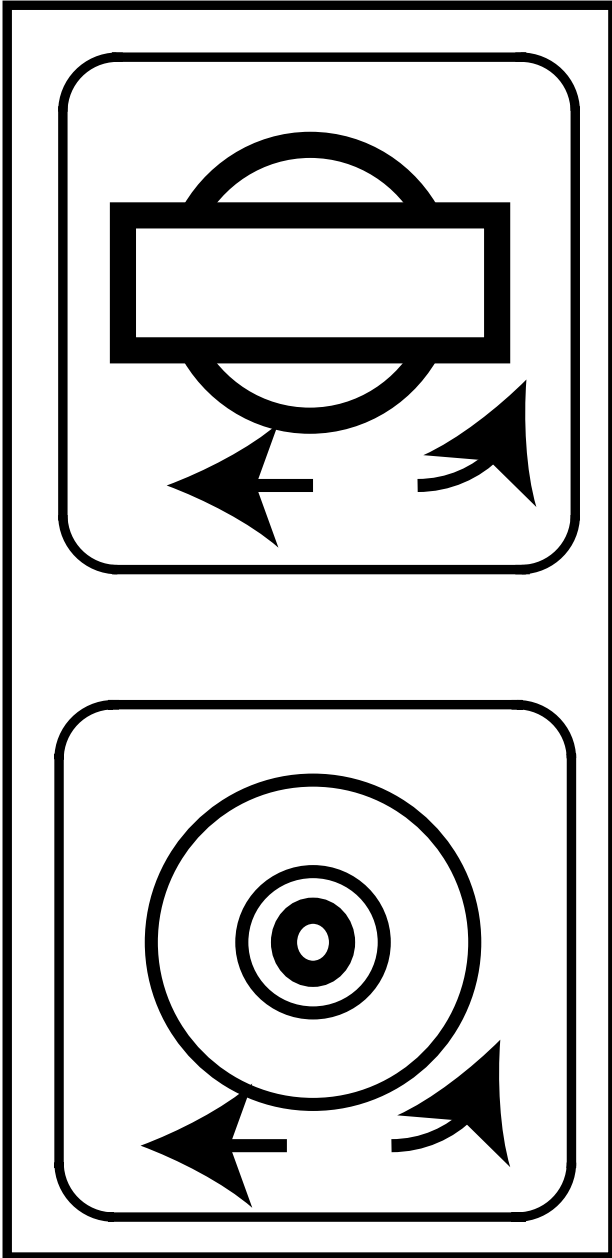

Park Brake



Automatic Vibration



Vibration Amplitude

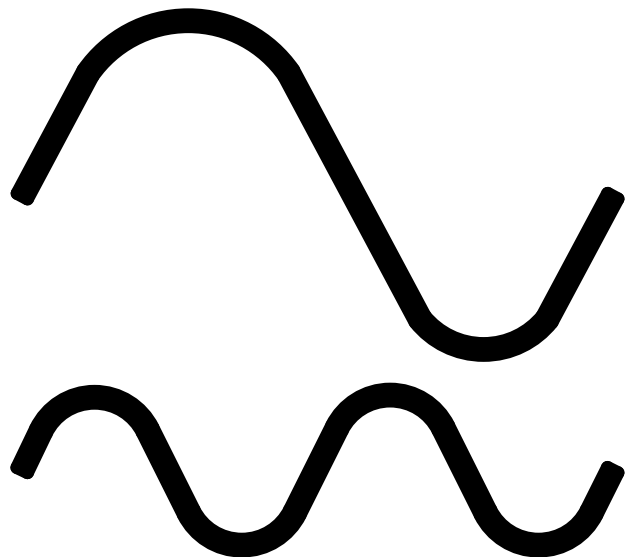

Two Speed Range

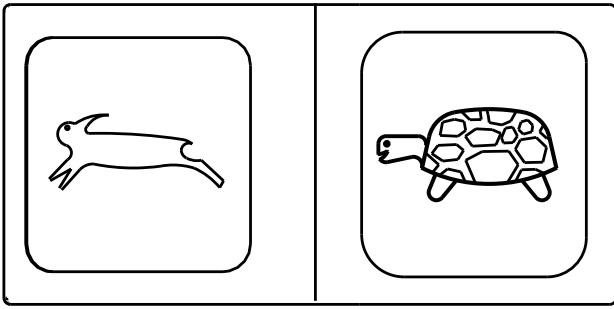

Lifting Points

Lifting Points

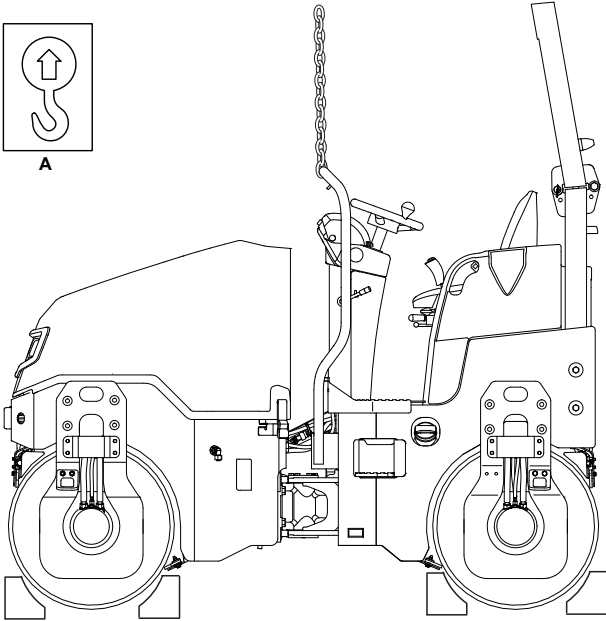
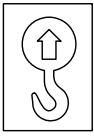

A Lifting label

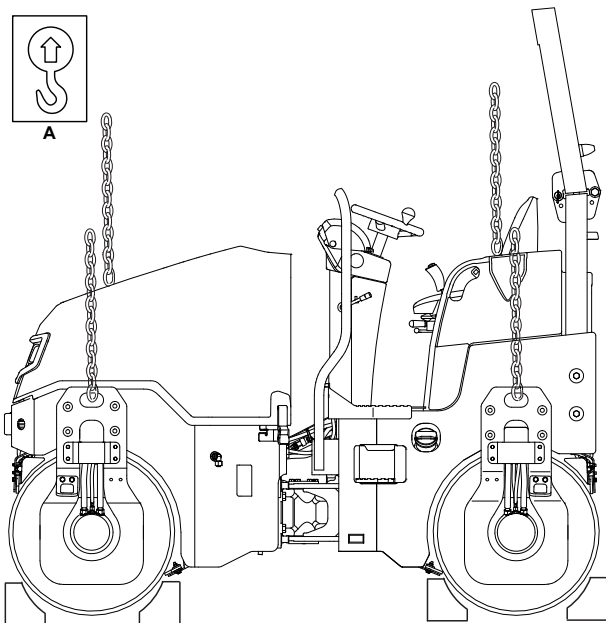
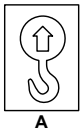

A Lifting label

Tie Down Points

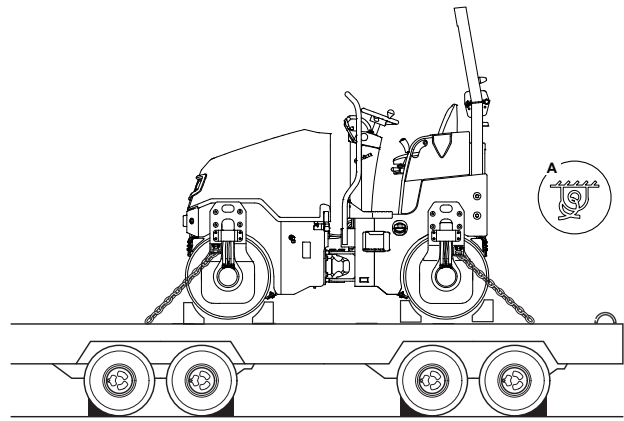

A Tie down decal

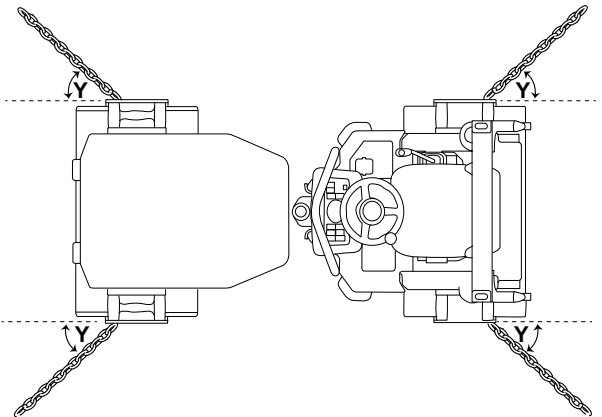
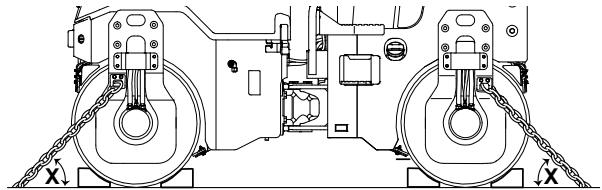

X 35°
Y 45°

Lashing Capacity

	Force	Proof Force	Breaking Force
Forward	5,896N	7,370N	11,792N
Backward	5,896N	7,370N	11,172N
Laterally	1,801N	2,252N	3,603N

Operator Maintenance Tasks

Operator Maintenance Tasks (For: CT160, CT260)

Component	Task	10	50
Engine			
Oil Level	Check	○	○
Coolant Quality/ level	Check	○	○
Coolant or Oil Leaks	Check	○	○
Exhaust smoke.	Check		○

Component	Task	10	50
Water Separator	Check for Contamination and Drain		○
All Hoses - Condition	Check	○	○
FEAD (Front End Accessory Drive) belt	Check (condition/tension)		○
Fuel pipes and clamp bands	Check		○
Air filter dust valve	Check	○	○
Drum and Steering			
Drum Scrapers	Clean	○	○
Drum Distance Spacers / Buffer ⁽¹⁾	Check		○
Hydraulics			
Operation all services.	Check		○
Oil	Check (Level)	○	○
Hoses - Damage or Leaks	Check	○	○
Rams - Chrome condition, leaks, security	Check		○
Electrics			
All electrical equipments operation (e.g. warning lights, beacon, alarm, horn etc)	Check	○	○
Operation of stop controls/ESOS (Engine Shut-Off Solenoid)	Check	○	○
Wiring for damage/routing	Check (Condition)		○
Battery Mounting	Check (Condition)		○
Battery Terminals for Condition and Tightness	Check (Condition)		○
Brakes			
Drive brake-operation	Check	○	○
Park brake -operation	Check	○	○
Transmission and steering.			
Vibration operation	Check	○	○
Sprinkler system operation.	Check	○	○
Bodywork and Cab			
Drum scrapers	Check	○	○
Operator's seat safety switch (if installed)	Check	○	○

Component	Task	10	50
Neutral start operation	Check	○	○
Safety Decals/Notes	Check	○	○
ROPS (Roll-Over Protective Structure)	Check (Condition)	○	○
Seat Belt - Condition, operation and security (If fitted)	Check	○	○
Machine Generally including paint-work	Check for Damage and Clean	○	○

(1) Check the tightness of the bolts/screws every day for the first week when machine is new.

Fuses and Relays

Secondary Fuses and Relays- Steering Column

▲ Notice: Always replace fuses with ones of correct ampere rating to avoid electrical system damage.

The electrical circuits are protected by fuses. If a fuse blows, find out why before a new one is installed.

The secondary fuses and relays are situated in the back side of steering column panel.

To get accesses to the secondary fuses and relays:

1. Make the machine safe.
2. Remove the screws.
3. Remove the panel.

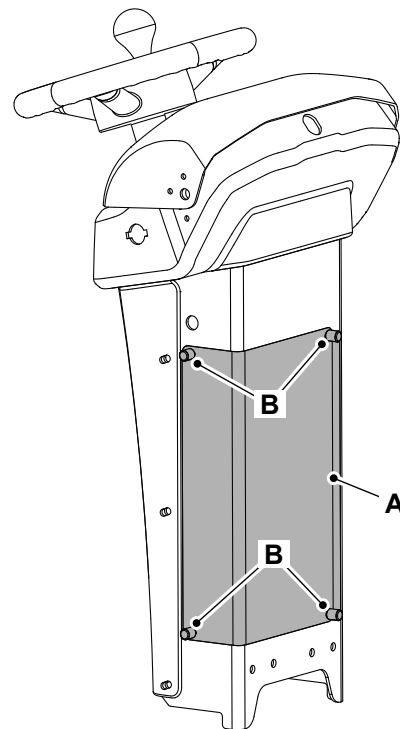

A Panel

B Screws

Primary Fuses- Engine Compartment cover

Open the engine compartment cover to get access to the primary fuses.

Dimensions

(For: CT160 [T4F/STV])

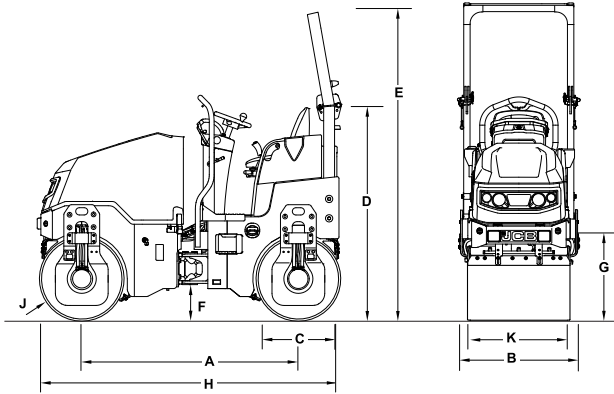

Item	Description	CT160-80	CT160-100
A	Wheelbase	1,560mm	1,560mm
B	Overall width	960mm	1,090mm
C	Drum diameter	580mm	580mm
D	Height to the top of seat	1,650mm	1,650mm
E	Height with ROPS	2,485mm	2,485mm
F	Ground clearance	255mm	255mm
G	Kerb clearance	510mm	510mm
H	Total travel length	2,140mm	2,140mm
J	Drum thickness	12mm	12mm
K	Drum width	800mm	1,000mm

(For: CT260 [T4F/STV])

Item	Description	CT260-100	CT260-120
A	Wheelbase	1,790mm	1,790mm
B	Overall width	1,095mm	1,295mm
C	Drum diameter	700mm	700mm
D	Height to the top of seat	1,755mm	1,755mm
E	Height with ROPS	2,510mm	2,510mm
F	Ground clearance	270mm	270mm
G	Kerb clearance	560mm	560mm
H	Total travel length	2,490mm	2,490mm
J	Drum thickness	12mm	12mm
K	Drum width	1,000mm	1,200mm

