



# LPG TLT

## QUICK REFERENCE GUIDE

This Quick Reference Guide DOES NOT replace the Operators Manual. You MUST read ALL the disclaimers and safety and other instructions in the Operators Manual before initially operating this product. Accordingly, no legal claims can be entertained based on the data, illustrations or descriptions in this Quick Reference Guide.

### BEST PRACTICES

1. Carry a load as low as possible while maintaining good visibility.
2. Forks should be tilted back when in transport – with or without a load, cradle the load.
3. Fork tips should be on the ground when unit is parked.

### Static Dimensions

Machine model		55-28G (25 LPG)	66-44G (30 LPG)	66-45G	
A	Overall length to fork face	ft-in 8-7	9	9-3	
B	Overall machine width	ft-in 3-10	4-2	4-7	
C	Height of overhead guard	Standard	ft-in 7-2	7-3	7-6
		Container (low)	ft-in 6-10	6-11	
		Wheelbase	ft-in 5-7		
D	Ground clearance				
E	At center of wheelbase	ft-in 0-6			
F	At lowest point	ft-in 0-5			

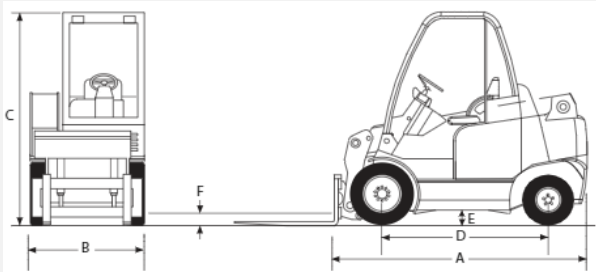

### Moving Machine

#### Lifting Machine

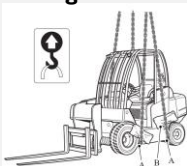

- A. Lifting point x 4
- B. Padding

#### Tie-Down Points



- A. Securing method

### Cab and Switch Panel

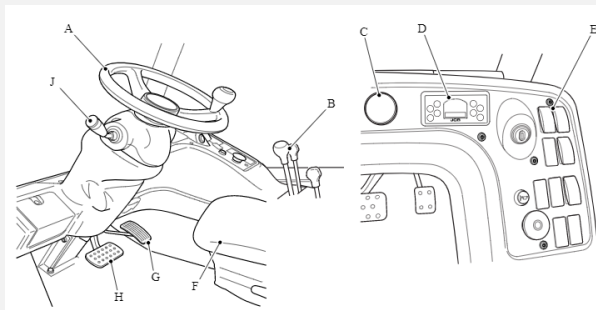

- A. Steering wheel
- B. Lift arm controls
- C. Coolant temperature gauge
- D. Instrument panel
- E. Console switches
- F. Seat
- G. Accelerator pedal
- H. Inching pedal
- J. Transmission drive lever

### Coolant Temperature Gauge

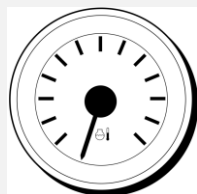

- A. 211.9 °F – Warning lamp on
- B. 220.9 °F – Reduced engine power
- C. 229.8 °F – Critical stop lamp illuminates. Further reduction in the engine power

### Transmission Drive Lever

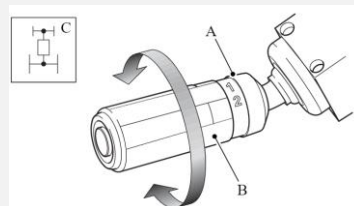

- A. Lever
- B. Twist grip
- C. Front differential indicator lamp

### Instrument Panel

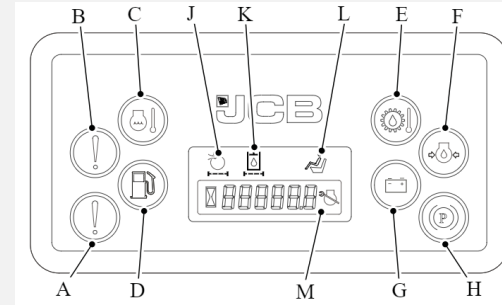

- A. Amber warning
- B. Critical stop (red)
- C. Engine coolant temperature (red)
- D. Not used
- E. Transmission oil temperature (red)
- F. Engine oil pressure (red)
- G. Alternator charge (red)
- H. Park brake (red)
- J. Air filter blocked
- K. Hydraulic filter
- L. Seat switch
- M. Hour meter / time to service / service due / fault code display

### Start Up Sequence

#### 1 Connect LPG Tank

Should be positioned in the cradle and secured; connect the tank to the hose making sure it is tight. There should be an audible release of gas into the hose.

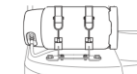

#### 2 Insert Isolator Key

Turn clockwise



#### 3 Fasten Seat Belt

Climb into the cab and fasten/adjust the seat belt



#### 4 Set to Neutral

Ensure the machine is not in gear and the parking brake is on

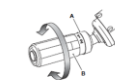

#### 5 Insert Key and Start

Turn the key to position II until the engine starts



#### 6 Operate Hydraulics

Operate hydraulics to make sure each function is working

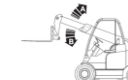

## Control Layout

### Boom Controls – Regular Pattern

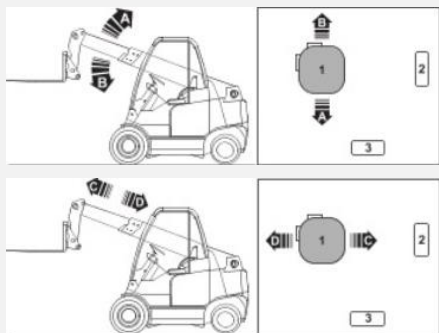

### Carriage Controls – Regular Pattern

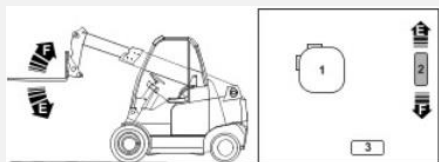

## Auxiliary Circuit Controls

### Auxiliary (option)

#### 3. Auxiliary Control

- G. Left auxiliary
- H. Right Auxiliary

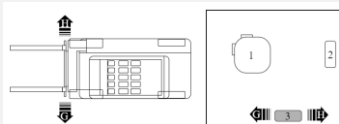

### Side-shift (option)

For side-shift press switch:

- 4. Side-shift Right
- 5. Side-shift Left

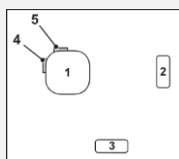

## Longitudinal Load Movement Indicator (LLMI)

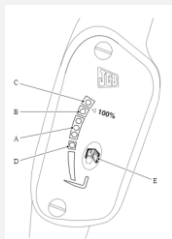

- A. Green LED - Safe when lit
- B. Amber LED (lit) – approaching limits
- B. Amber LED (flashing) – extend/lower disabled
- C. Red LED – Danger / at limit of stability
- D. Power ON indicator
- E. Display button

## Service Points

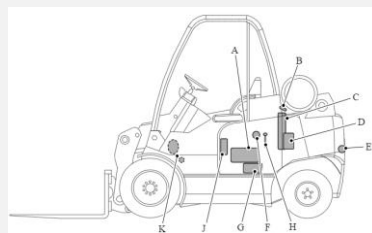

- A. Air intake
- B. Radiator cap
- C. Radiator
- D. Coolant expansion tank
- E. Battery isolator
- F. Engine oil filler cap
- G. Battery
- H. Engine oil dipstick
- J. Window washer fluid tank
- K. Hydraulic oil level indicator, hydraulic oil filler cap

## Access Covers

### Engine Side Panel

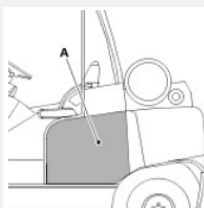

- A. Engine side panel

### Cab/Canopy

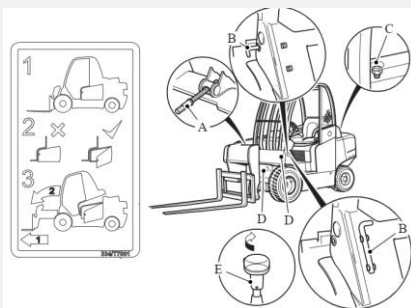

- A. Jack
- B. Tilt lock pin
- C. Cab bolts
- D. Front cover
- E. Hydraulic lever bolt and control knob

## Install Changezee Quickhitch Attachment

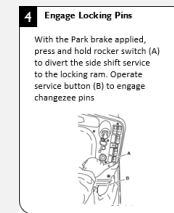
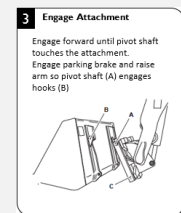
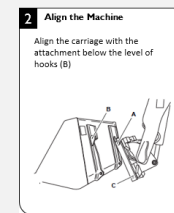

## Install Fork Attachment

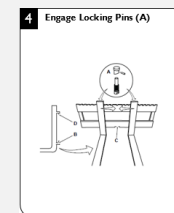
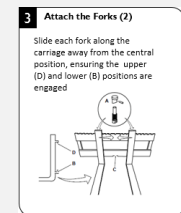
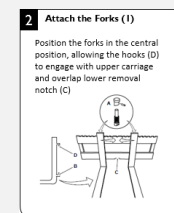

## Install Bucket Attachment

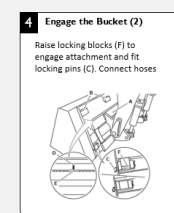
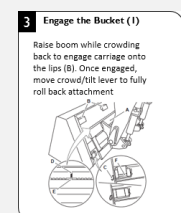
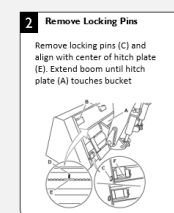

## 2 Insert Isolator Key

Turn clockwise

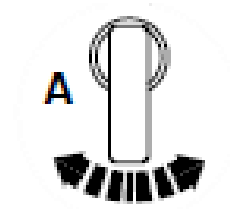

## 3 Fasten Seat Belt

Climb into the cab and fasten/adjust the seat belt



## 4 Set to Neutral

Ensure the machine is not in gear and the parking brake is on

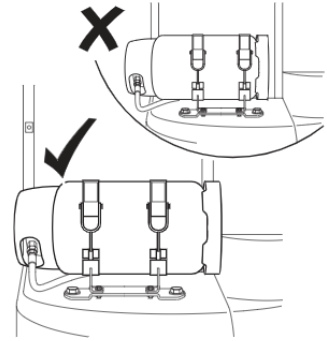
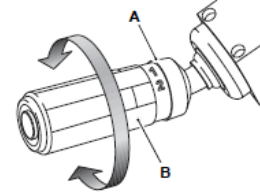

## 5 Insert Key and Start

Turn the key to position II until the engine starts

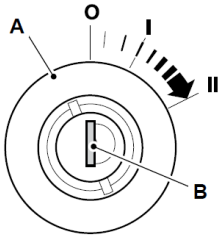

## 6 Operate Hydraulics

Operate hydraulics to make sure each function is working

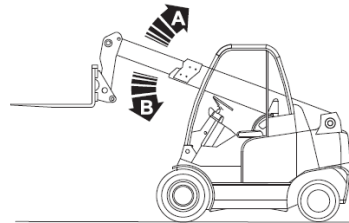

## 1 Connect LPG Tank

Should be positioned in the cradle and secured; connect the tank to the hose making sure it is tight. There should be an audible release of gas into the hose.

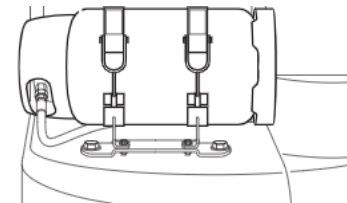

## 1 Stop the Machine

Park on dry level ground

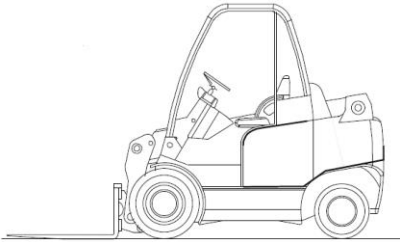

## 2 Align the Machine

Align the carriage with the attachment below the level of hooks (B)

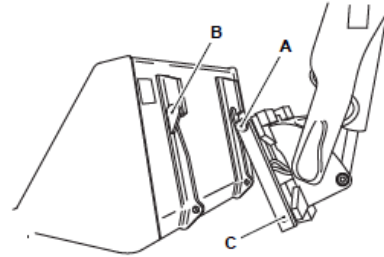

## 3 Engage Attachment

Engage forward until pivot shaft touches the attachment.  
Engage parking brake and raise arm so pivot shaft (A) engages hooks (B)

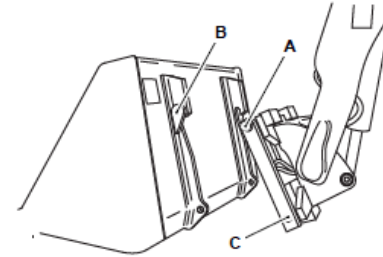

## 4 Engage Locking Pins

With the Park brake applied, press and hold rocker switch (A) to divert the side shift service to the locking ram. Operate service button (B) to engage changezee pins

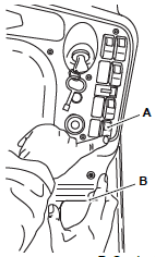

## 1 Stop the Machine

Park on dry level ground

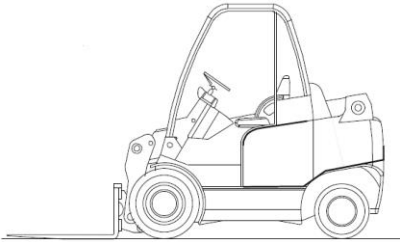

## 2 Attach the Forks (1)

Position the forks in the central position, allowing the hooks (D) to engage with upper carriage and overlap lower removal notch (C)

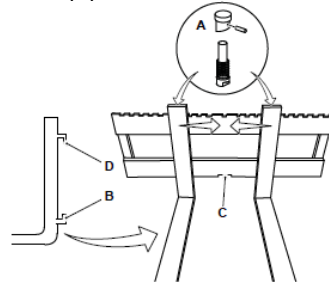

## 3 Attach the Forks (2)

Slide each fork along the carriage away from the central position, ensuring the upper (D) and lower (B) positions are engaged

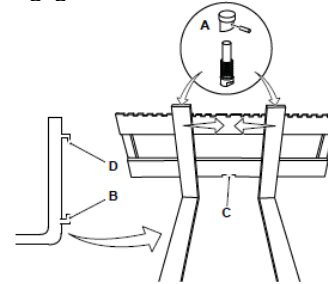

## 4 Engage Locking Pins (A)

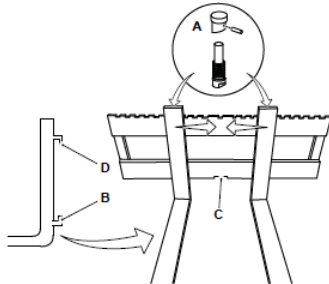

## 1 Stop the Machine

Park on dry level ground

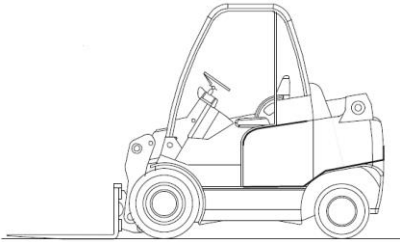

## 2 Remove Locking Pins

Remove locking pins (C) and align with center of hitch plate (E). Extend boom until hitch plate (A) touches bucket lips (B).

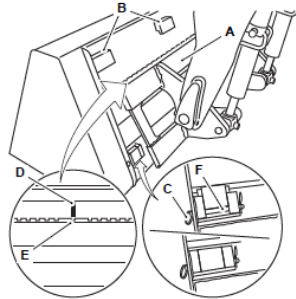

## 3 Engage the Bucket (1)

Raise boom while crowding back to engage carriage onto the lips (B). Once engaged, move crowd/tilt lever to fully roll back attachment

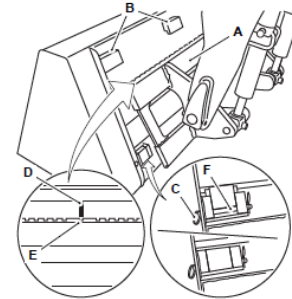

## 4 Engage the Bucket (2)

Raise locking blocks (F) to engage attachment and fit locking pins (C). Connect hoses

