



JZ141

QUICK REFERENCE GUIDE

This Quick Reference Guide DOES NOT replace the Operators Manual. You MUST read ALL the disclaimers and safety and other instructions in the Operators Manual before initially operating this product. Accordingly, no legal claims can be entertained based on the data, illustrations or descriptions in this Quick Reference Guide.

Static Dimensions

Monoboam

Machine model		JZ141			
		LC		HD	
A	Track length on ground	ft-in	9-5	10-1	
B	Undercarriage overall length	ft-in	11-9	12-6	
C	Track gauge	ft-in	6-6	7-3	
D	Width over tracks (1'8" trackshoes)	ft-in	8-2	-	
	Width over tracks (2' trackshoes)	ft-in	8-6	9-2	
	Width over tracks (2'4" trackshoes)	ft-in	8-10	9-6	
	Width over tracks (2'7" trackshoes)	ft-in	-	9-10	
	Width over tracks (2'9" trackshoes)	ft-in	9-4	-	
E	Width over tracks (2'11" trackshoes)	ft-in	-	10-2	
	Counterweight clearance	ft-in	3	3-4	
H	Tailswing radius	ft-in	4-10	4-10	
I	Width of superstructure	ft-in	8-2	8-2	
J	Height over cab	ft-in	9-4	9-8	
K	Height over grab rail	ft-in	10-7	10-11	
L	Ground clearance	ft-in	1-5	1-5	
M	Track height	ft-in	2-8	2-9	

Machine model		JZ141							
		LC				HD			
Dipper lengths	ft-in	6-11	8-2	8-10	9-10	6-11	8-2	8-10	9-10
E Transport length	ft-in	24	24-1	23-10	23-11	24	24-1	23-10	23-11
F Transport height	ft-in	10-7	10-7	10-10	10-11	10-11	10-11	11-2	11-3
F Transport height with handrail folded (optional)	ft-in	9-6	9-7	10-10	10-11	9-10	9-11	11-2	11-3

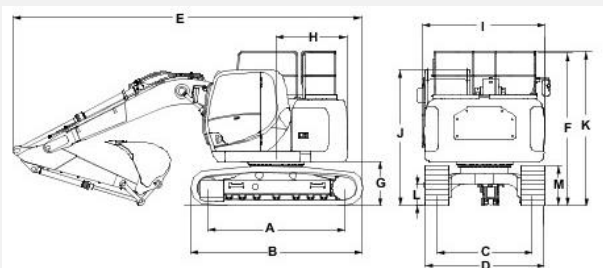

Cab and Switch Panel

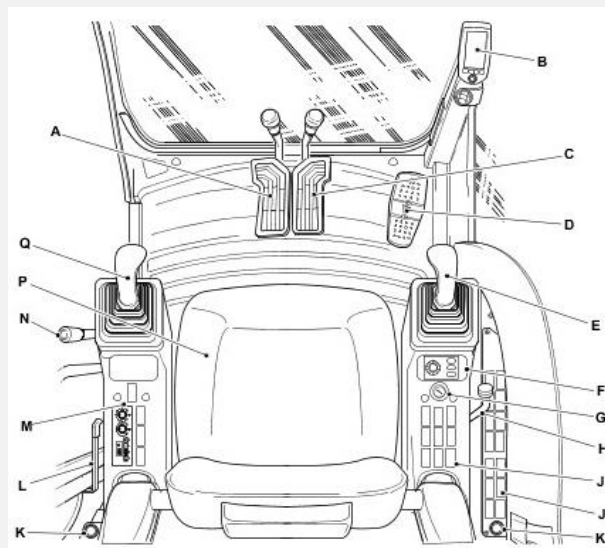

- A. Left hand track control
- B. DECU
- C. Right hand track control
- D. Circuit pedal (option)
- E. Right joystick
- F. Machine power band controllers
- G. Ignition switch
- H. Dozer lever
- J. Right switch console
- K. 12V auxiliary power socket
- L. Door lever
- M. Left switch console
- N. Controls isolation lever
- P. Seat
- Q. Left joystick

Tie Down Points

- A. Undercarriage securing method
- B. Dipper securing method

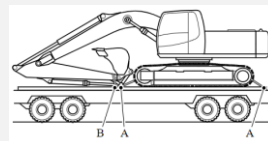

Instrument Panel

- A. Back button
- B. Minus button
- C. Home button
- D. Plus button
- E. Enter button
- F. Rotary control and select button
- G. Fault indicator

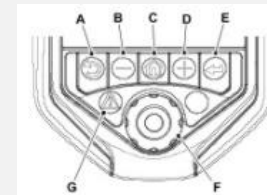
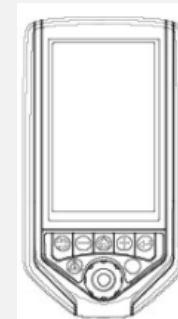

- A. Travel speed
- B. Auto idle/Controls isolation
- C. Clock
- D. Inside/outside temperature, Fan speed, A/C
- E. Engine speed
- F. Power band

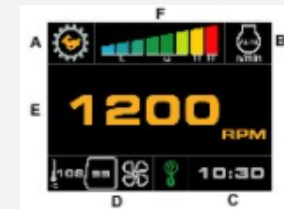

Start Up Sequence

- 1 Insert Isolator Key (E)**
 Insert isolator key switch, push and turn 90 degrees
- 2 Isolate Machine**
 Ensure the left isolation lever (A) is in the raised position
- 3 Disarm the Immobiliser**
 If installed, use rotary to enter code
- 4 Start Machine**
 Turn ignition key to the on position (3) and hold till engine starts
- 5 Lower Isolation Lever**
 Ensure the left isolation lever (A) lowered to activate the hydraulics
- 6 Operate Machine**
 All controls are now active and the machine is ready to use

Access additional information
www.servicepro.jcb.com



Excavator End Controls

Left Joystick (ISO)

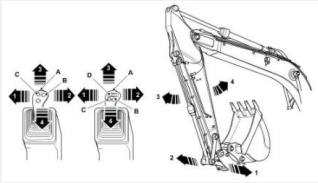

1. Slew to the left
2. Slew to the right
3. Move dipper outwards
4. Move dipper inwards

- A. Auxiliary hold (proportional control only)
- B. Boom priority (if fitted)
- C. Horn
- D. Proportional auxiliary control high flow (option)

Right Joystick (ISO)

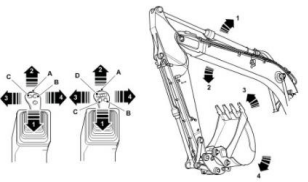

1. Raise the boom
2. Lower the boom
3. Fill the bucket
4. Empty the bucket

- A. Power boost
- B. Quickhitch
- C. One touch idle
- D. Proportional auxiliary control low flow (option)

TAB (option)

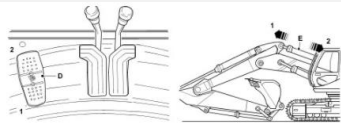

- A. Pedal
 - B. Ram
1. Extend the ram
 2. Retract the ram

Dozer Blade Controls



- A. Control lever
- B. Lower the dozer blade
- C. Lift the dozer blade

Auxiliary Circuit Controls

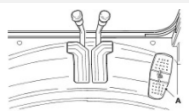

- A. Auxiliary control pedal

- A. Change-over valve (Bucket to grab option)

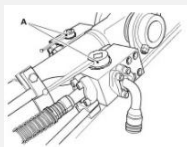

Service Points

Upper Structure

- A. Engine oil dipstick
- B. Radiator cap and expansion bottle
- C. Engine oil filler cap
- D. Diesel level indicator
- E. Fuel filler cap
- F. Hydraulic tank breather
- G. Hydraulic oil filler cap

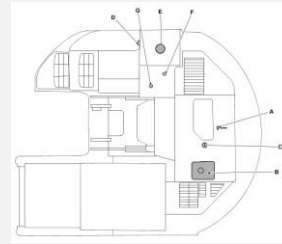

Battery Compartment

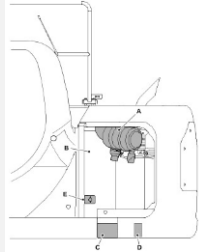

- A. Air intake
- B. Radiator(s)
- C. Batteries
- D. Window washer fluid bottle
- E. Battery isolator

Hydraulic Compartment

- A. Main fuel filter
- B. Hydraulic oil level indicator
- C. Primary fuel filter
- D. Engine fuel filter

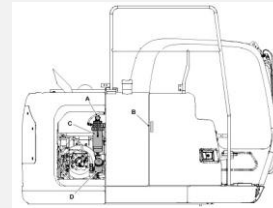

Undercarriage

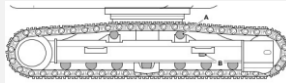

- A. Track rollers
- B. Track tensioner

Access Covers

Battery Cover

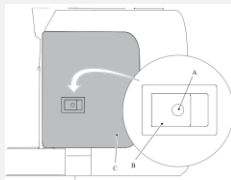

- A. Lock
- B. Handle
- C. Cover

Engine Compartment Cover

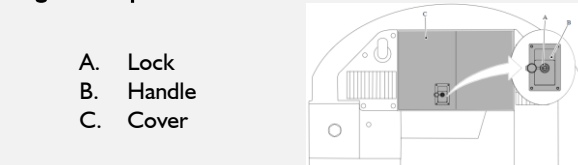

- A. Lock
- B. Handle
- C. Cover

Access Covers

Hydraulic Compartment Cover

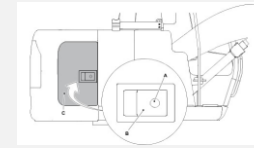

- A. Lock
- B. Handle
- C. Cover

Radiator Cover

- A. Lock
- B. Handle
- C. Cover
- D. Cap Cover

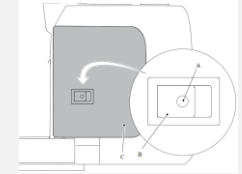

Hydraulic Hitch Unlock Sequence

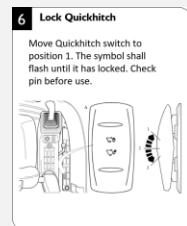
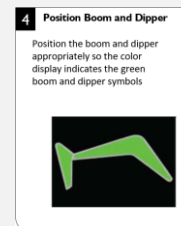
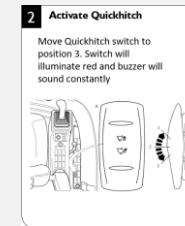

Lifting the Machine

- A. Spacer bars
- B. Lifting platform
- C. Lifting-hook height
- D. Angle = 75°

