



220X

QUICK REFERENCE GUIDE

This Quick Reference Guide DOES NOT replace the Operators Manual. You MUST read ALL the disclaimers and safety and other instructions in the Operators Manual before initially operating this product. Accordingly, no legal claims can be entertained based on the data, illustrations or descriptions in this Quick Reference Guide.

Static Dimensions

Machine model		220X		
		LC	SLC	SC
A	Track length on ground	ft-in	12	11-1
B	Undercarriage overall length	ft-in	14-8	13-8
C	Track gauge	ft-in	7-10	7-1
D	Width over tracks (1'8" shoes)	ft-in	9-6	8-9
	Width over tracks (2' shoes)	ft-in	9-10	9-1
	Width over tracks (2'4" shoes)	ft-in	10-2	9-5
	Width over tracks (2'7" shoes)	ft-in	10-6	9-9
	Width over tracks (2'11" shoes)	ft-in	10-10	-
G	Counterweight clearance	ft-in	3-6	
H	Tail length	ft-in	9-3	
J	Width of superstructure	ft-in	8-10	
K	Height over cab	ft-in	9-11	
L	Minimum ground clearance	ft-in	1-7	
M	Track height with triple grouser shoes	ft-in	2-11	
N	Tail swing radius	ft-in	9-4	
P	Overall height of upper structure	ft-in	10-5	

Machine model		220X			
Boom Option		Mono		TAB	LR
	Dipper lengths	ft-in	7-10 9-10	7-10 9-10	21
E	Transport length (including hoses & pipes)	ft-in	31-7 31-4	31-7 30-10	41-2
F	Transport height (including hoses & pipes)	ft-in	10-6 10-1	10-9 10-4	10-1

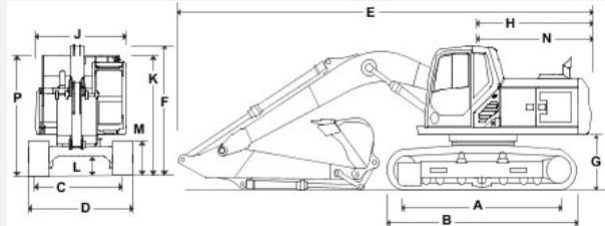

Tie Down Points

- A. Undercarriage securing method
- B. Dipper securing method

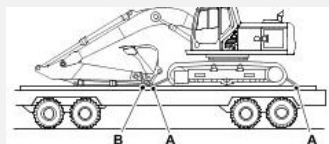

Cab and Switch Panel

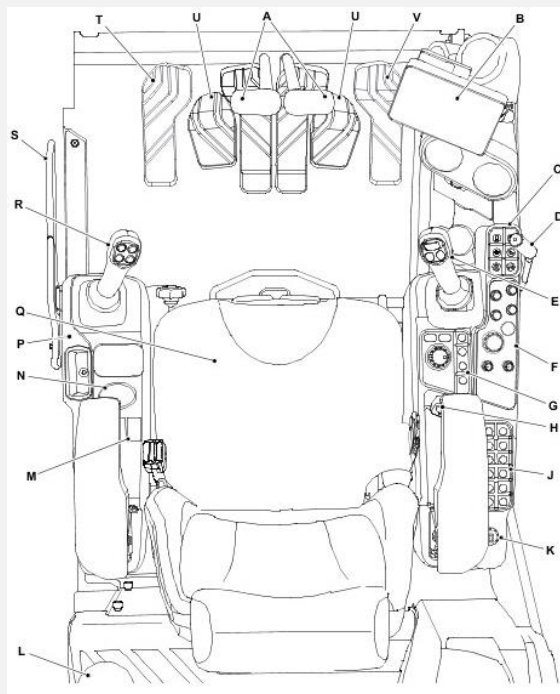

- A. Track controls
- B. Display unit
- C. Switch panel
- D. Dozer control (option)
- E. Right joystick
- F. Dial control panel
- G. Display control panel
- H. Auxiliary power socket/media socket
- J. Switch panel (option)
- K. Ignition switch
- L. Fire extinguisher (option)
- M. Option switches/ 360° camera
- N. Winter control panel (option)
- P. Engine stop and courtesy switches
- Q. Operator seat
- R. Left joystick
- S. Control isolation lever
- T. TAB foot pedal (option)
- U. Foot rest
- V. Hammer-auxiliary foot pedal (option)

Instrument Panel

- A. Upper ribbon icons
- B. Ambient temperature
- C. Clock
- D. Machine hours
- E. Camera screen (if selected)
- F. Volume or phone/media
- G. Source/detail information
- H. Engine RPM
- J. Power Band
- K. Lower Ribbon HVAC icons
- L. HVAC/Fan speed
- M. Fuel level gauge
- N. Coolant temperature gauge
- P. DEF fluid level gauge
- Q. Hydraulic oil temperature gauge

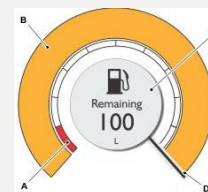
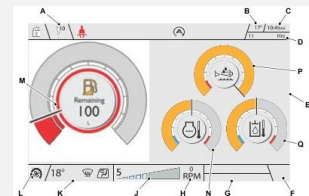

- A. Warning band
- B. Main band
- C. Fuel information
- D. Needle

Start Up Sequence

1 Insert Isolator Key
Insert isolator key (A) and turn in a clockwise direction.

2 Check Isolation Lever
Ensure the hydraulic isolation lever is in the lower position (B).

3 Engage Seat Belt
Engage seat belt (A) into latch (B) before starting machine.

4 Engine Pre Heat
Turn ignition to position 1 (A).

5 Start Machine
Hold down the Start/Stop button until the machine starts.

6 Raise LH Isolator lever
Raise the left hand isolator lever (A) to activate the hydraulics.

7 Press 2 GO Button
If enabled press 2 GO button (A) to activate hydraulics. Hydraulic isolation icon (B) will disappear from the dash when active.

8 Operate Machine
All controls are now active and the machine is now ready to use.



Excavator End Controls

Left Joystick (ISO)

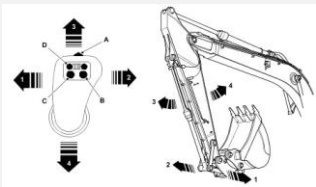

1. Slew to the left
2. Slew to the right
3. Move dipper outwards
4. Move dipper inwards

- A. Auxiliary hold (proportional control only)
- B. Boom/slew priority (if fitted)
- C. Horn
- D. Proportional auxiliary control high flow (option)

Right Joystick (ISO)

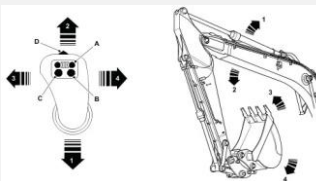

1. Raise the boom
2. Lower the boom
3. Fill the bucket
4. Empty the bucket

- A. Proportional auxiliary control low flow (option)
- B. Quickhitch
- C. One touch engine idle
- D. Power boost

TAB (option)

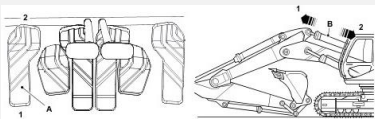

- A. Pedal
- B. Ram
- 1. Extend the ram
- 2. Retract the ram

Dozer Blade Controls

- A. Control lever
- B. Lower the dozer blade
- C. Lift the dozer blade

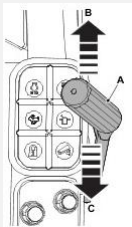

Auxiliary Circuit Controls

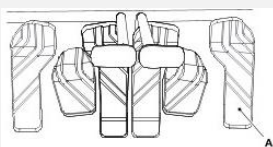

- A. Auxiliary control pedal

Service Points

Upper Structure

- A. DEF filler cap
- B. Diesel fuel filler cap
- C. Hydraulic oil filler cap
- D. Engine oil dip stick
- E. Engine oil filler cap
- F. Coolant expansion tank
- G. Slew gearbox filler
- H. Slew gearbox dipstick
- J. Blower booster filter (optional)
- K. Slew gear inspection plate
- L. Hammer filter

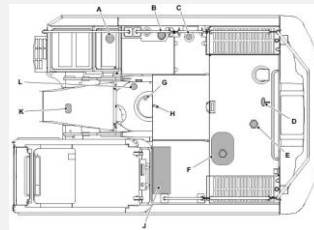

Upper Structure

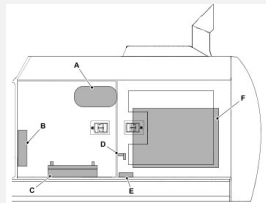

- A. Air filter
- B. Fuse and relay box
- C. Batteries
- D. Battery isolator
- E. Window washer fluid bottle
- F. Radiator(s)

Hydraulic Compartment

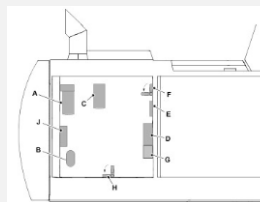

- A. Main fuel filter
- B. Engine oil filter
- C. Lubricity filter (option)
- D. Fuel sedimenter
- E. Hydraulic oil level indicator
- F. Fuel tap
- G. Water separator
- H. Fuel tank drain tap
- J. Servo filter

Undercarriage

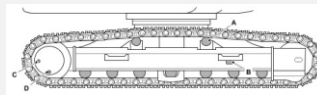

- A. Track rollers
- B. Track tensioner
- C. Track fill/level
- D. Track drain

Upper step – DEF filler access

- A. Latch
- B. Cover
- C. DEF tank filler cap

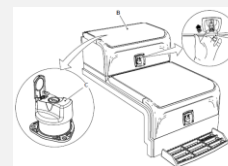

Lower step – Toolbox/refuel pump access (if fitted)

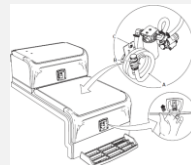

- A. Fuel hose
- B. Close-off valve
- C. Switch

Hydraulic Quickhitch

Standard Attachments

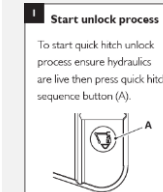

1. Start unlock process
To start quick hitch unlock process ensure hydraulics are live then press quick hitch sequence button (A).

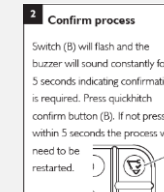

2. Confirm process
Switch (B) will flash and the buzzer will sound constantly for 5 seconds indicating confirmation is required. Press quickhitch confirm button (B). If not pressed within 5 seconds the process will need to be restarted.

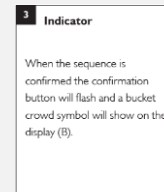

3. Indicator
When the sequence is confirmed the confirmation button will flash and a bucket crowd symbol will show on the display (B).



4. Remove attachment
To disengage the quickhitch jaws, crowd the attachment for 3 seconds. The attachment can now be removed.

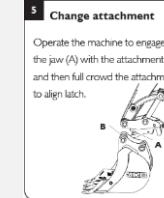

5. Change attachment
Operate the machine to engage the jaw (A) with the attachment (B) and then full crowd the attachment to align latch.

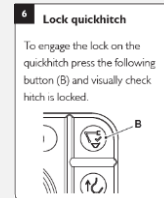

6. Lock quickhitch
To engage the lock on the quickhitch press the following button (B) and visually check hitch is locked.

Specialized Attachments

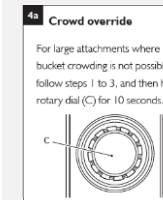

- 4a. Crowd override
For large attachments where bucket crowding is not possible follow steps 1 to 3, and then hold rotary dial (C) for 10 seconds.

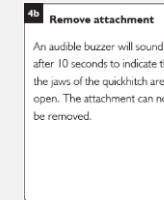

- 4b. Remove attachment
An audible buzzer will sound after 10 seconds to indicate that the jaws of the quickhitch are open. The attachment can now be removed.

Lifting Mode



1. Mode selection
Activate button (A) on controller 2.

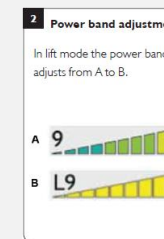

2. Power band adjustment
In lift mode the power band adjusts from A to B.

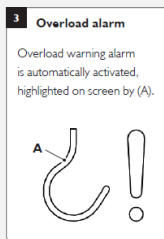

3. Overload alarm
Overload warning alarm is automatically activated, highlighted on screen by (A).

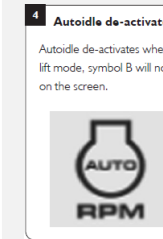

4. Autoidle de-activate
Autoidle de-activates when in lift mode, symbol B will not be on the screen.

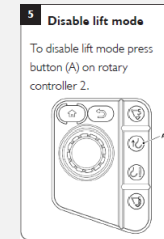

5. Disable lift mode
To disable lift mode press button (A) on rotary controller 2.

Lifting Machine



- A. Lifting points
- B. Lifting decal